

SKE

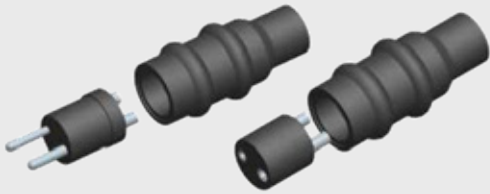

SECONDARY CONNECTOR KITS

COMPLIANCES

FAA: AC150/5345-26

ICAO: Aerodrome Design Manual - Part 5

APPLICATIONS

When it is not possible the direct coupling between the lights and the relative isolation transformers, to realize suitable secondary extensions two-pole connector kits are available for on-site direct application to the cable ends in a few minutes by the electrical installer following simple illustrated instructions.

SKE secondary kits are designed for 600 V cables and 20 A maximum current.

Metal plug and receptacle fittings are crimped onto the conductors and then inserted into the molded rubber bodies.

Plug and receptacle secondary kits are available, suitable for single-pole or two-pole cables.

FEATURES

- Secondary plug kit for two single conductor cables
Designed to meet FAA specification L-823, style 4, each kit forms a plug for two single conductor cables for connection to a secondary receptacle kit or to an isolation transformer. Both cables must be the same size
- Secondary receptacle kit for two single conductor cables
Designed to meet FAA specification L-823, style 11, each kit forms a receptacle for two single conductor cables for connection to a secondary plug kit. Both cables must be the same size
- Secondary plug kit for two-pole conductor cables
Designed to meet FAA specification L-823, style 5, each kit forms a plug for a two-pole conductor cable for connection to a secondary receptacle kit or to an isolation transformer.
- Secondary plug kit for two-pole conductor cables
Designed to meet FAA specification L-823, style 12, each kit forms a receptacle for a two-pole conductor cable for connection to a secondary plug kit.

SKE - OP - A6

Secondary kit model: _____

Cable type: _____

0 = Two single-pole

1 = One two-pole

Kit type: _____

P = Plug

R = Receptacle

Cable diameter: _____

(see Table 1)

Conductor size: _____

(see Table 2)

Table 1		
Cable diameter (mm)		Code
minimum	maximum	
2,8	4,0	A
2,8	3,4	B
3,8	5,5	C
5,0	8,0	D
8,5	13,5	E
11,5	18,0	F

Table 2		
Conductor size		Code
sqmm	AWG	
1.5 – 2.5	16 - 14	6
4 - 6	12 – 10/8	4

Shipping Weights and Volumes

	SKE
Weight (kg)	0,050
Volume (m ³)	0,0003

We reserve the right to change the design or specification data without notice

UC-PU-0292_EN

Multi Electric Mfg., Inc.4223 W Lake Street Chicago, IL 60624 - Tel: 773.722.1900 Fax: 773.722.5694
sales@multielectric.com - www.multielectric.com