



# LERA

## LED ELEVATED APPROACH, THRESHOLD, THRESHOLD WING BAR AND RUNWAY END LIGHT



### COMPLIANCES

**ICAO:** Annex 14 - Volume I Fig. A2-1, A2-2, A2-3, A2-4, A2-8

**FAA:** L-862S AC150/5345-46

**IEC:** TS 61827

**NATO:** STANAG 3316

**CAA:** CAP 168

**IAAE:** TP312

### APPLICATIONS

Approach, Threshold, Threshold Wing Bar and Runway End for ICAO CAT I, II and III and military runways  
Used for Stop Bar lighting on ICAO/FAA taxiways

### BENEFITS

- 60000 hours LED rated life at full intensity, but over 100000 hours in field operating conditions
- In new installation, LED lights mean lower loads, lower size of CCRs and transformers, thus low life cycle costs
- The light output is variable like a traditional halogen lamp, as indicated by the FAA "Engineering Briefing No.67"
- Colour emitted directly by LEDs: absence of coloured filters ensures no energy losses and no colour shifts
- Fully compatible with existing AFL infrastructure\*
- Designed with simplicity allowing longer maintenance intervals and fewer spare parts
- Transparent front protection mechanically fastened to the body by means of a suitable frame with silicone gasket, making its replacement quick and easy
- No optical adjustment after LED module or lens array replacement
- Operating with any topology of CCRs designed in compliance with IEC or FAA requirements

\* For monitored fixtures, isolation transformer max size: 150VA

### PERFORMANCES

- The electronic is strong-built and highly resistant to shock and vibration
- Automatic adaptation to the frequency of the supply current
- A surge protection device is provided in the electronics as required by the FAA "Engineering Briefing No.67"
- Immediate detection of an internal fault
- Lightweight and sturdy due to aluminium die-castings
- Powder coating surface finishing to provide good corrosion resistance
- Body balanced on a special support for proper and accurate horizontal and vertical aiming
- High jet blast resistance due to the small size of the Threshold and Runway End fixture, 310 mm high
- Protection degree: IP67
- Temperature range: -55°C to +55°C

### INSTALLATION

- The fixture can be installed on pipe elbow or baseplate
- Specific tools available for easy and precise installation

**PHOTOMETRIC PERFORMANCES**

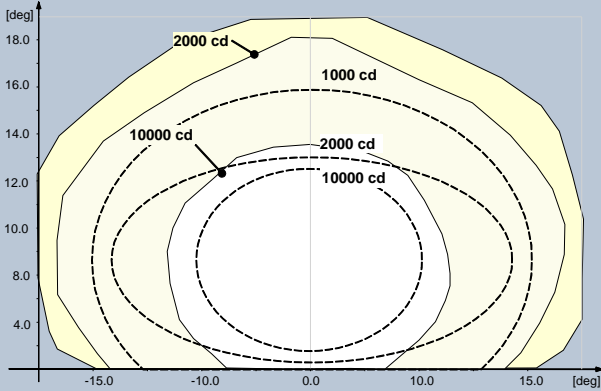

Fig. 1 ICAO Fig. A2-1 – White

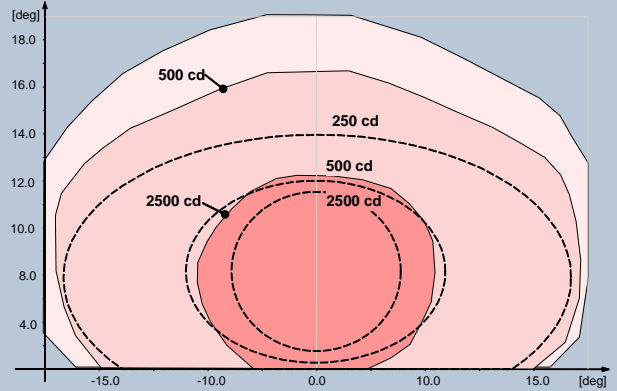

Fig. 2 ICAO Fig. A2-2 – Red

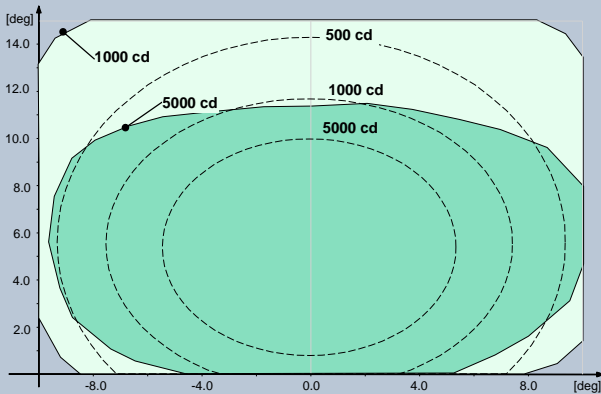

Fig. 3 ICAO Fig. A2-4 – Green

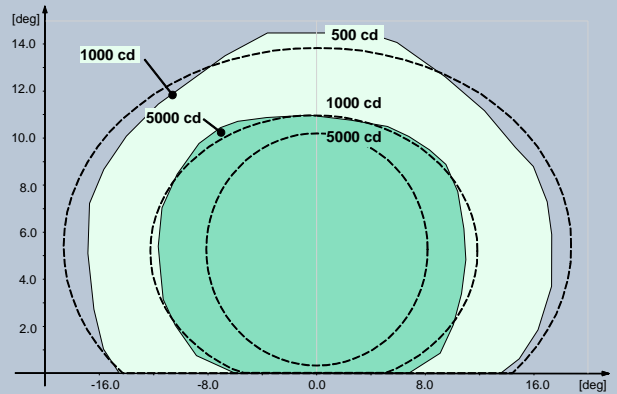

Fig. 4 ICAO Fig. A2-3 – Green

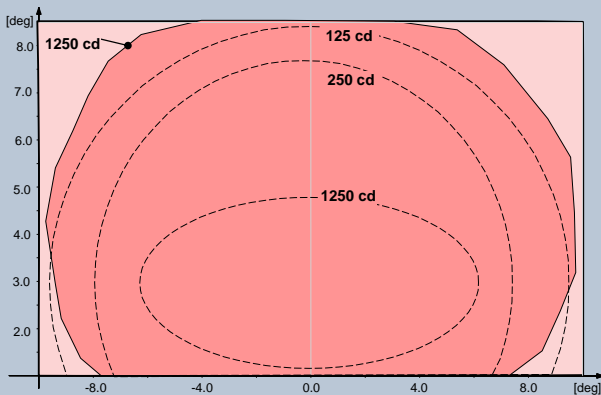

Fig. 5 ICAO Fig. A2-8 – Red

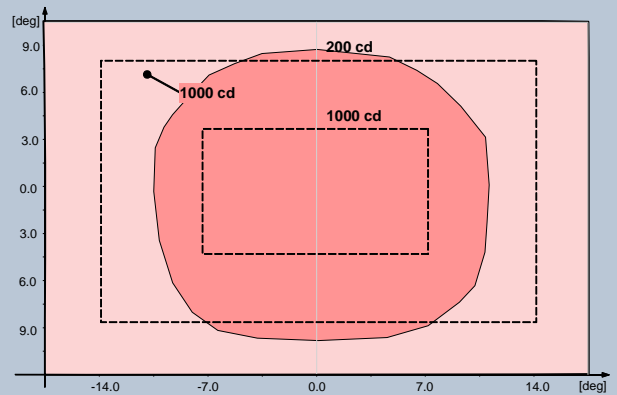
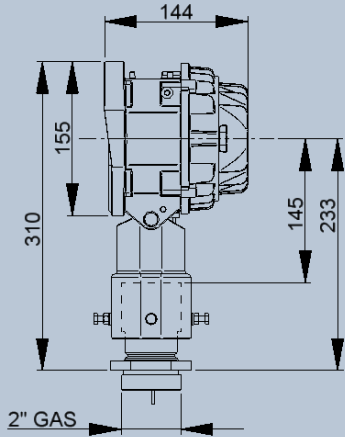

Fig. 6 FAA L-862S – Red

**TABLES**

POWER CONSUMPTION * (w/o Arctic Kit)	
Electrical System	1 Plug
Approach White	38VA
Approach Red	26VA
Threshold/Threshold Wing Bar Green	30VA
Runway End/FAA Stop Bar	20VA
ICAO Stop Bar	17VA
* Measured at 6.6 A	

POWER FACTOR		
Input Step	2.8 A	6.6 A
Power Factor	0.96	0.98



Configuration P-001

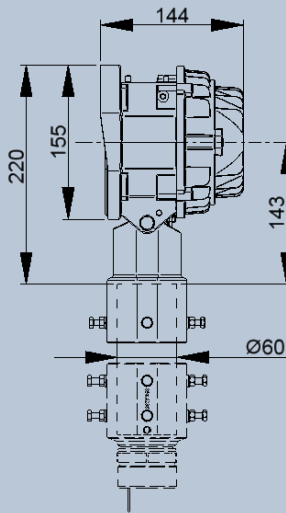

Configuration C-050

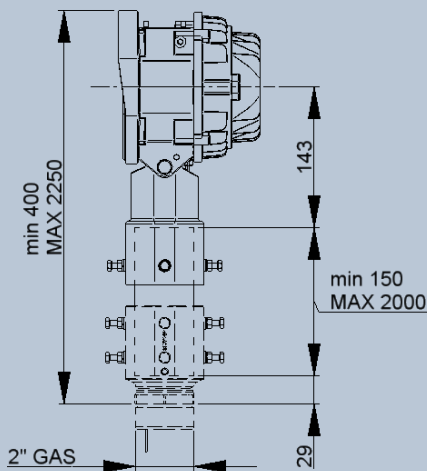

Configuration C-250

**LERA - AC - P-001 - 0 - 0**

**Basic P/N:** \_\_\_\_\_

**Use Code:** \_\_\_\_\_  
(Refer to TABLE A)

**Configuration:** \_\_\_\_\_

- P-001 = Fixture complete with breakable coupling
- C-050 = Fixture with special support and cable lead (L= 0.5 m)(\*)
- C-250 = Semi-assembled fixture (AC and AR only)(\*) (\*\*)
- C-000 = Fixture without cable lead (\*)

**Monitoring:** \_\_\_\_\_

- 0 = Without Monitoring
- M = With Monitoring

**Arctic Kit:** \_\_\_\_\_

- 0 = Without Arctic Kit

- (\*) Supporting pole and breakable coupling must be ordered separately
- (\*\*) This configuration is provided with special support and cable lead (L = 2.5 m) not assembled

**TABLE A**

CODE	USE	COLOUR
AC	Approach centreline and crossbars	WHITE
AR	Approach side row	RED
TG	Threshold	GREEN
WG	Threshold wing bar	GREEN
ER	Runway end	RED
SB	FAA Stop bar	RED
BA	ICAO Stop bar	RED

**RENEWAL PARTS FOR LIGHT UNIT**

- 1 Cover with electronic
- 2 Cover gasket
- 3 LED module support
- 4 LED module support gasket
- 5 LED module
- 6 Lens array for LED module
- 7 Body
- 8 Transparent front protection gasket
- 9 Transparent front protection
- 10 Transparent front protection holder plate (painted in the colour of the emitted light)
- 11 Vertical aiming adjusting device
- 12 Special support
- 13 FAA L-823 plug
- 14 Breakable coupling

Refer to the relevant technical manual for the complete list

**ACCESSORIES**

- 013.0010 Set of two ryton rings for receptacle support inside pipe elbow
- 013.0008 Galvanized steel pipe elbow with upper threaded end only (2" - 11 GAS thread)
- 315.3210 Galvanized steel pipe elbow with both threaded ends (2" - 11 GAS thread)
- 315.1228 Base L-867, Class IA, Size B, 24" Deep
- 315.1062 Baseplate for L-867 base with gasket and cable clamp (2" - 11 GAS thread)
- 303.6135 Breakable coupling for LERA configuration C-050 or C-250
- 315.3710 Supporting pole (H = 150 mm)
- 315.3711 Supporting pole (H = 500 mm)
- 315.3712 Supporting pole (H = 1000 mm)
- 315.3713 Supporting pole (H = 1500 mm)
- 315.3714 Supporting pole (H = 2000 mm)
- 332.4560 Levelling and alignment device for light on supporting pole
- 332.3240 Levelling and alignment device for light on frangible mast
- 332.4571 Support for device P/N 332.3240
- 798.0006 Special tubular wrench 22 mm for bulkhead connector

For any information about isolating transformers and connectors, please see the specific catalogue pages

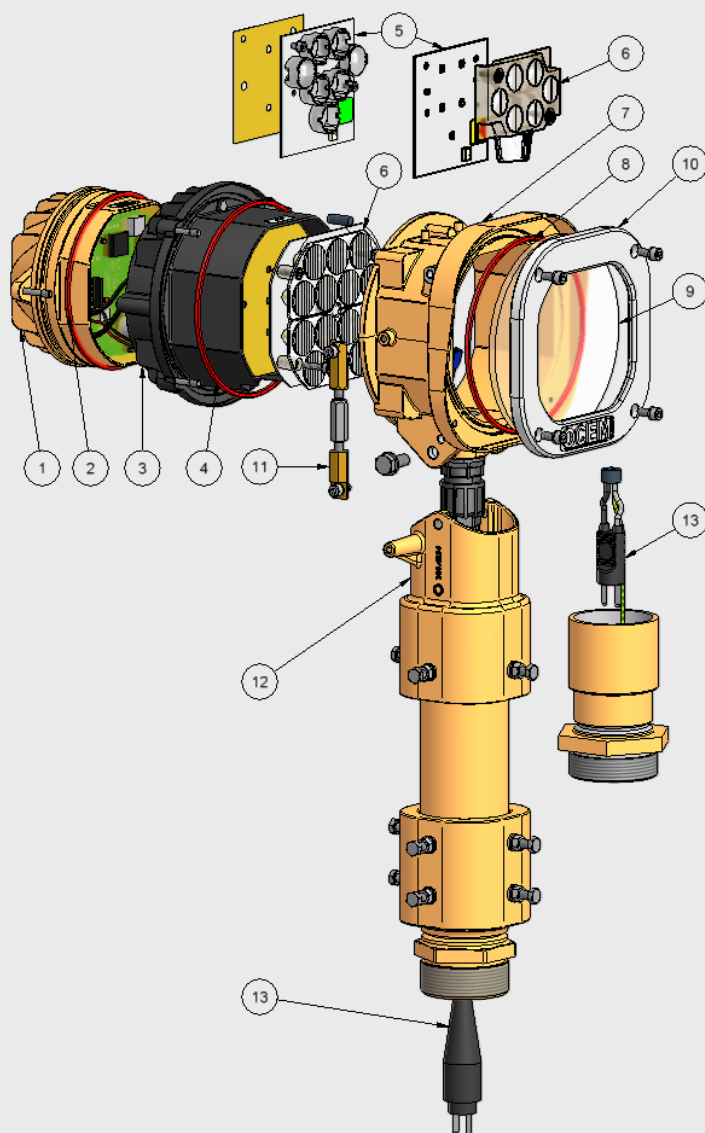
**Shipping Weights and Volumes**

	Light Type P-001	Light Type C-050	Light Type C-250
<b>Weight (kg)</b>	4.4	4.1	5.0
<b>Volume (m<sup>3</sup>)</b>	0.019	0.019	0.019

We reserve the right to change the design or specification data without notice

UC-PU-0304\_EN