

LTA04



LED INSET TAXIWAY CENTERLINE, STOP BAR AND INTERMEDIATE HOLDING POSITION LIGHT

COMPLIANCES

FAA: L-852A-B-C-D-J-K (L) AC150/5345-46 and EB No.67

ICAO: Annex 14 - Volume I Fig. A2-12-13-14-15-16

IEC: TS 61827

NATO: STANAG 3316

CAA: CAP 168

IAAE: TP312



APPLICATIONS

Taxiway centerline, stopbar and intermediate holding positions for FAA, ICAO CAT I,II and III and military taxiway

BENEFITS

- 60,000 hours LED rated life at full intensity, but over 100,000 hours in field operating conditions
- In new installation, LED lights mean lower loads, smaller CCRs and transformers, thus lower life cycle costs
- The light output is variable like a traditional halogen lamp, per FAA "Engineering Briefing No.67"
- Color is produced by LEDs: without colored filters ensuring no energy losses and no color shifts
- Fully compatible with existing AFL infrastructure*
- Designed with simplicity allowing longer maintenance intervals and fewer spare parts
- No use of sealant to fix the prisms in the dome thanks to customized gaskets, making their replacement quick and easy
- No optical adjustment after LED module or prism replacement
- Valve for watertightness test after overhaul
- Operating with any style of CCRs designed in compliance with FAA or IEC requirements

* For monitored fixtures, isolation transformer max size: 200VA

PERFORMANCES

- The electronics are built strong and highly resistant to shock and vibration
- Automatically adapts for 50 or 60 Hz current frequency
- Surge protection is provided per FAA "Engineering Briefing No.67"
- Immediate internal fault detection
- The mere .25 inch (6.35 mm) protrusion strongly reduces vibrations to aircrafts and to the fixture itself, increasing its life expectancy
- The smooth top dome profile makes the fixture less vulnerable to snowplough blades
- Bidirectional or unidirectional, 8 or 12 inch dia.
- Drop-forged dome and cast aluminium lower cover make the fixture sturdy, but lightweight for ease of handling in the field
- The shallow light channel in front of the prism makes the light output practically unaffected by heavy rain
- An O-Ring is provided outside the dome to minimize dirt deposits between fixture and base
- Protection degree: IP67
- Temperature range: -55°C to +55°C

INSTALLATION

- Suitable for 12" dia. bases
- Specific tools available for easy and precise installation

PHOTOMETRIC PERFORMANCES

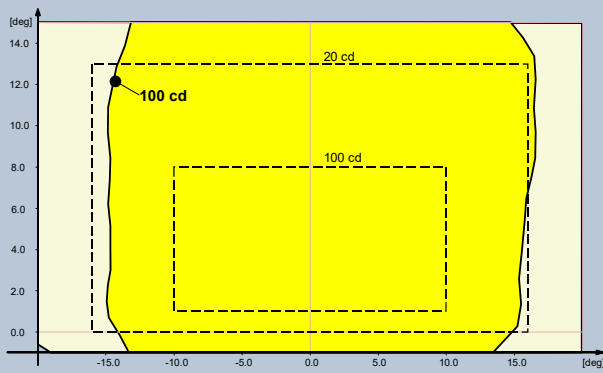

Fig. 1 ICAO A2-12 Straight Section – Yellow

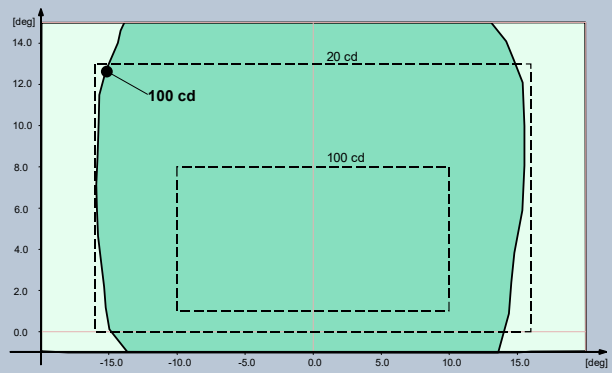

Fig. 2 ICAO A2-12 Straight Section – Green

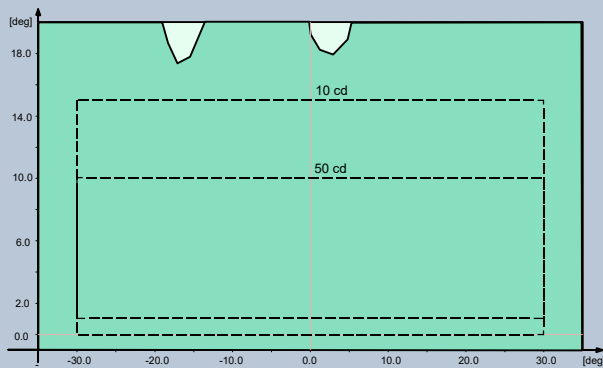

Fig. 3 FAA L-852D – Green

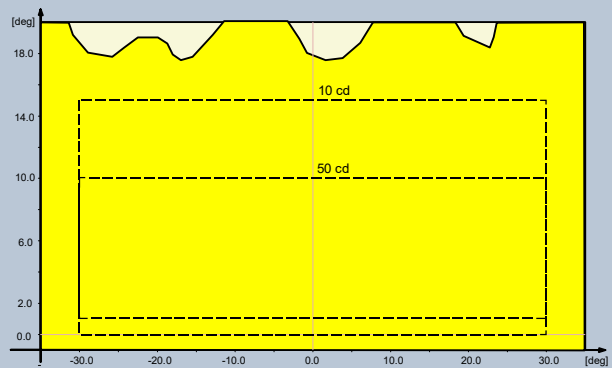

Fig. 4 FAA L-852D – Yellow

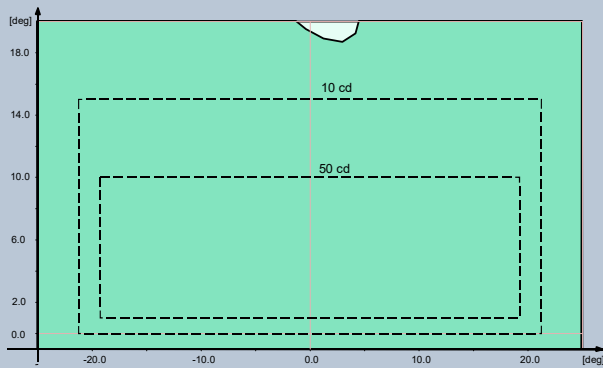

Fig. 5 FAA L-852K – Green

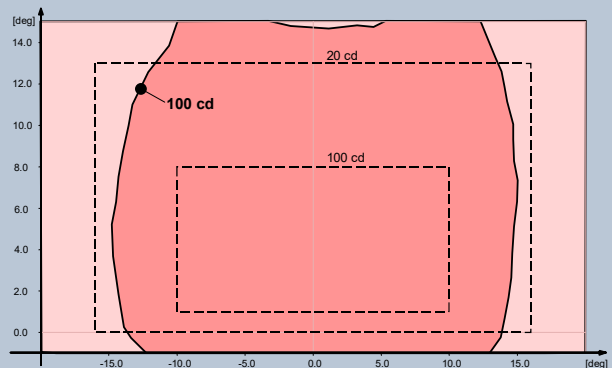

Fig. 6 ICAO A2-12 Straight Section – Red

TABLES

POWER CONSUMPTION*

Electrical System	1 Plug	2 Plugs
Unidirectional (w/o Arctic Kit)	7 VA	-
Unidirectional (with Arctic Kit)	47 VA	-
Bidirectional (w/o Arctic Kit)	12 VA	14 VA
Bidirectional (with Arctic Kit)	52 VA	94 VA

* Measured at 6.6 A and referred to the highest consumption configuration

POWER FACTOR

Input Step	2.8A	6.6A
Power Factor	0.96	0.98

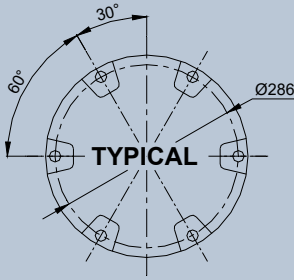

Light Fixture 12" dia.

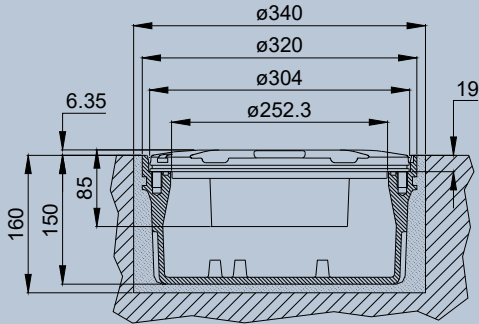

Shallow Base 12" dia.

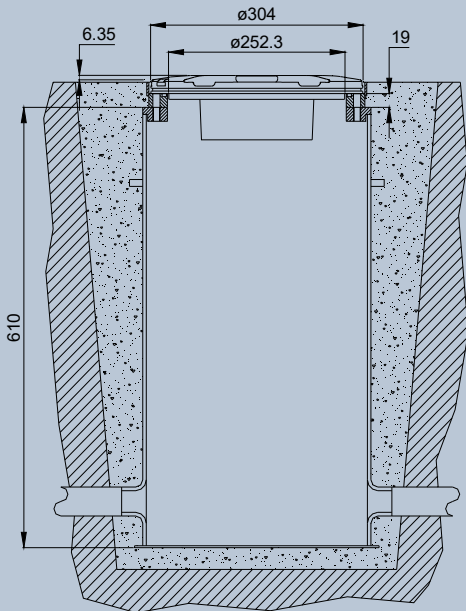

L-868 Deep Base 12" dia.

LTA1204 - F - D - GG - 2P - 0 - M - A

Basic P/N: _____

LTA1204 = 12" Diameter

LTA0804 = 8" Diameter

Compliance: _____

I = ICAO CAT III

S = ICAO CAT I-II

F = FAA

Use Code: _____

(Refer to TABLE A)

Color (Side A)/(Side B)*: _____

G = Green

Y = Yellow

R = Red (not for FAA)

S = Screened

M = Blank (unidirectional dome)**

Electrical System: _____

1P = One Plug

2P = Two Plug

Mounting Assembly: _____

0 = No mounting Assembly

R = Adapter Ring 8" to 12" (LTA0804 series only)

Monitoring: _____

0 = Without Monitoring

M = With Monitoring

Arctic Kit: _____

0 = Without Arctic Kit

A = With Arctic Kit

TABLE A

USE	I = ICAO CAT III	S = ICAO CAT I-II	F = FAA
A	Fig. A2.12 straight wide	Fig. A2.15 straight	L-852A
B			L-852B
C	Fig. A2.13 straight narrow		L-852C
D			L-852D
W	Fig. A2.14 curved	Fig. A2.16 curved	
K			L-852K
J			L-852J

* For curved sections it's necessary to specify the color of each side, "A" and "B", due to the fixture toe-in

** The aperture not finished "M", on straight sections fixtures, will be always on side "B"

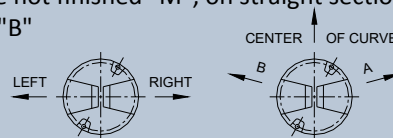

Straight and Curved Section Orientation

RENEWAL PARTS FOR LIGHT UNIT:

- 1 Dome
- 2 O-Ring for dome
- 3 O-Ring for lower cover
- 4 Prism Gasket
- 5 Prism
- 6 Prism holder gasket
- 7 Mounting plate
- 8 Lower cover with electronic, plug and valve
- 9 Valve for watertightness test
- 10 Arctic Kit heater
- 11 Arctic Kit thermostat
- 12 LED module with accessories
- 13 Reflector with hardware
- 14 FAA L-823 plug

Refer to the technical manual for the complete list of the available spare parts

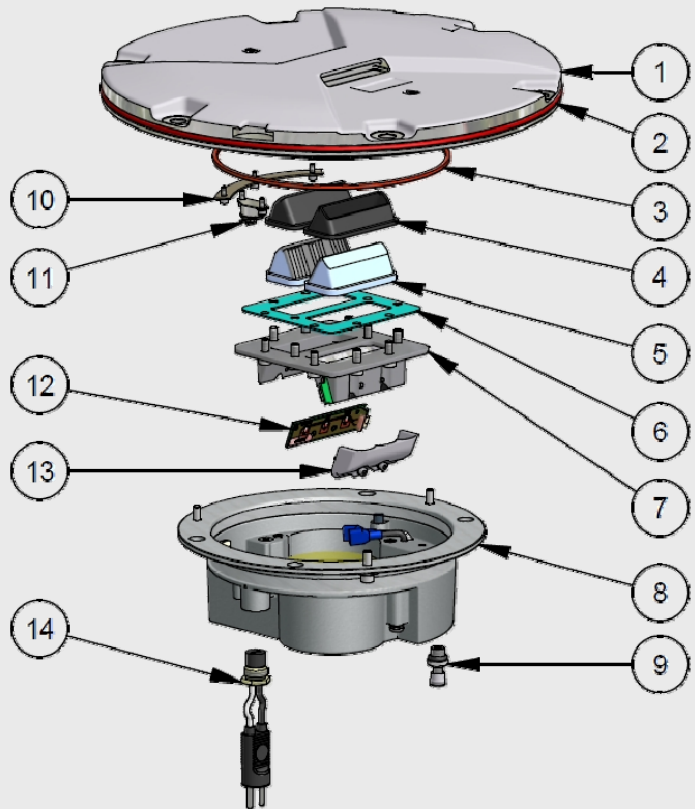
**Shipping Weights and Volumes**

	Light Unit	Shallow base
Weight Lbs(kg)	13 (5.9)	16 (7.3)
Volume Ft³(m³)	0.78 (0.022)	0.78 (0.022)

We reserve the right to change the design or specification data without notice

LTA-LED_US-Rev.A

Multi Electric Mfg., Inc.

4223 W Lake Street Chicago, IL 60624 - Tel: 773.722.1900 Fax: 773.722.5694
 sales@multielectric.com - www.multielectric.com



Via 2 Agosto 1980, 11
 40016 San Giorgio di Piano – Bologna (Italy)
 Tel: +39 051 66 56 611 - Fax: +39 051 66 56